



## Jefferson Alumni Hall Renovations Update

Week of Nov. 10, 2014

	Contractor	Area of Work	Dates	Description of Work	Impact
Current	P. Agnes, Inc. Superintendent, Charlie Morgan	West Side on Entrance	Complete mid Nov. 2014	Construction on West side of entrance including the sidewalk	Occupants must use the East side of Locust Street Entrance. Intermittent loud noise and vibration.
	SimplexGrinnell Superintendent John Burn	1st floor & Mezz	Complete Nov. 2014	The Fire Alarm is being replaced throughout the building.	Intermittent loud noise and drilling. Work will be schedule with occupants.
	P. Agnes, Inc. Superintendent, Charlie Morgan	Escalator Demolition and new stair Construction	Oct. 13, 2014 to March 2015	Escalators will be demolished and new stairs will be constructed in their stead.	Occupants will have to use new and modernized elevators and existing fire stairs. Major noise and vibration.
	P. Agnes, Inc. Superintendent, Charlie Morgan	Modernization of Exist. Passenger Elev.	Oct. 20, 2014 to Jan. 2015	The existing passenger elevator will be modernized; therefore it will be out of services	Two new elevators will be functioning for use. Intermittent loud noise and vibration.
Coming	Canuso Jorden Superintendent, John McKeown	East & West Locust Lounges	Nov. 2014 to May 2015	Construction of two Lounges on the Locust street side of building aligned with the atriums	Intermittent loud noise and drilling.
Future	TBD	1st Fl & Mezz Finishes	TBD	Replacement of brick flooring with terrazzo, plaster ceilings with suspended acoustical & painting walls.	Intermittent loud noise and jack hammering of floors
	TBD	Eakins Lounge Renovation	TBD	Construction of two Lounges on the Locust street side of building aligned with the atriums	Intermittent loud noise and drilling.



Since 1918 • Building Contractors • Construction Managers

TJU - JAH Entrance & Elevators  
PAI Job # 12613

**THREE WEEK LOOK AHEAD SCHEDULE**

Week of:		November 3 through November 7					November 10 through November 14					November 17 through November 21								
Scope of Work	Contractor	Su	3	4	5	6	7	Sa	10	11	12	13	14	Sa	17	18	19	20	21	Sa
<b>Basement - Gym</b>																				
Complete Rubber Flooring	CFS																			
Complete Painting	T3																			
<b>West Exterior</b>																				
Plaster	Deltz																			
Tree Trenches	Nico																			
Sidewalks & Curbs	HLJ																			
Granite & Pavers	East Penn																			
Railings	Berlin																			
Paint & Caulk	T3 & Pioneer																			
Top Soil, Irrigation & Plantings	Nico																			
Caulk	Pioneer																			
Punchlist	Misc.																			
<b>West Lobby</b>																				
Paint	T3																			
Revolver	ADE																			
Floor Topping	CSI																			
Porcelain Tile	Belfi																			
Complete Air Curtains, Radiators & Grates	HGC & Berlin																			
Clean & Remove ICRA	PAI																			
Caulk	Pioneer																			
Punchlist	Misc.																			
<b>Escalator Removal</b>																				
Complete Stripping of Escalators	Central																			
Rig & Remove Escalator Frame & Box 1-M	Central																			
Rig & Remove Escalator Frame & Box M-2	Central																			
Rig & Remove Escalator Frame & Box 2-3	Central																			
Rig & Remove Escalator Frame & Box 3-4	Central																			
<b>Existing Elevator</b>																				
Modernization	Otis																			

<b>Anticipated Milestone Dates</b> Escalator Removal      Week of 10/13 - 12/5/14 Stair Installation      11/17/14 - 1/9/15 West Exterior              11/14/2014 West Lobby                11/14/2014	<b>P. Agnes, Inc.</b> 2101 Penrose Avenue Philadelphia, PA 19145	<b>Thomas Jefferson University</b> Philadelphia, PA	Date of Issuance: <u>11/4/14</u>
--	--	--	----------------------------------

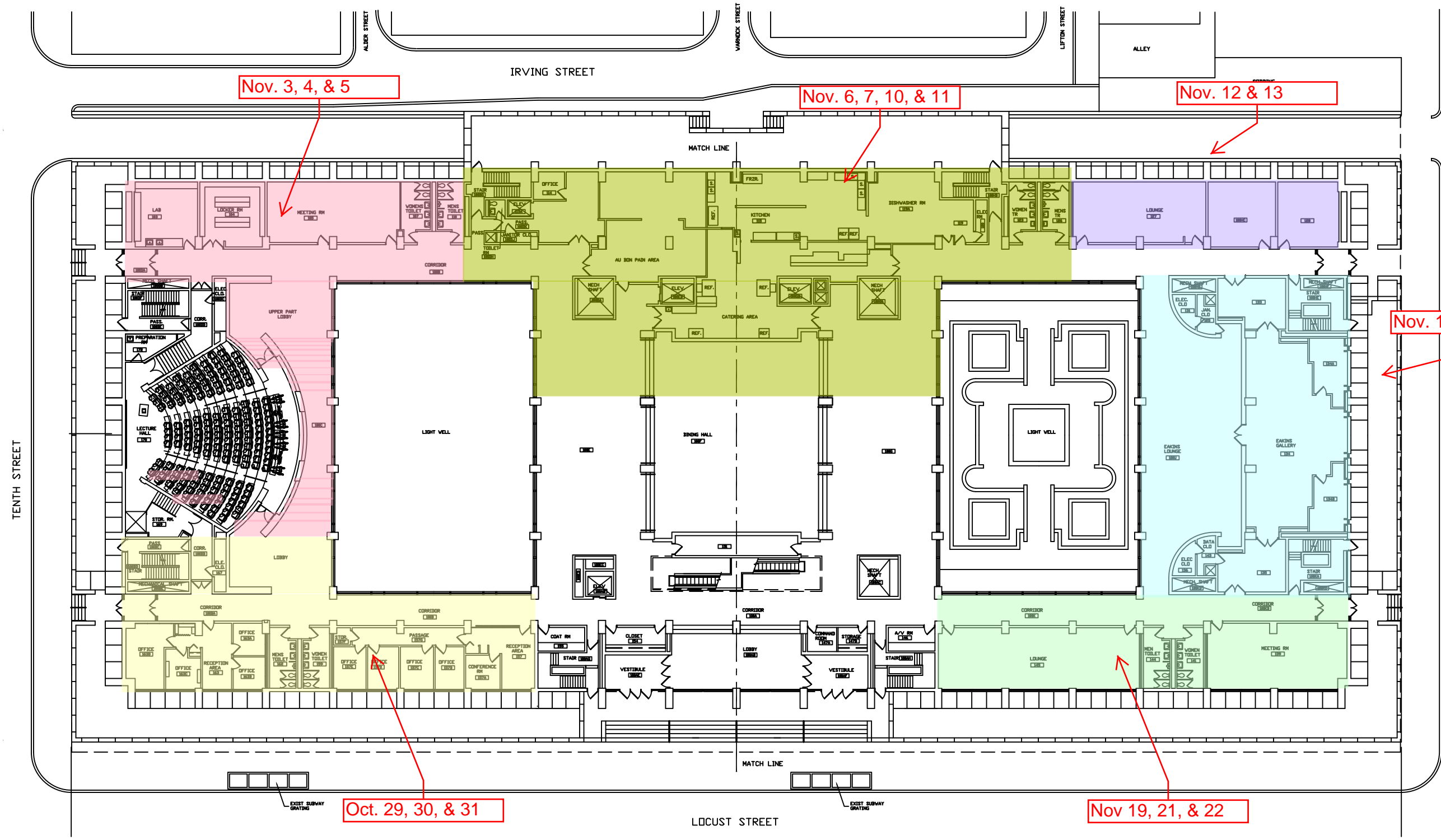

# JEFFERSON ALUMNI HALL 1ST FLOOR



DWG. NO.	10-01
DATE	11/30/01
SCALE	1/32"=1'-0"
PROJ. NO.	11X17
FILE NO.	10-01
DRAWN BY	S.G.
PROJ. MGR	

## MASTER JEFFERSON ALUMNI HALL 1ST FLOOR

Department of  
Facilities Design  
& Construction

Thomas  
Jefferson  
University